

IT Help Desk - Received 7/1/18 TML

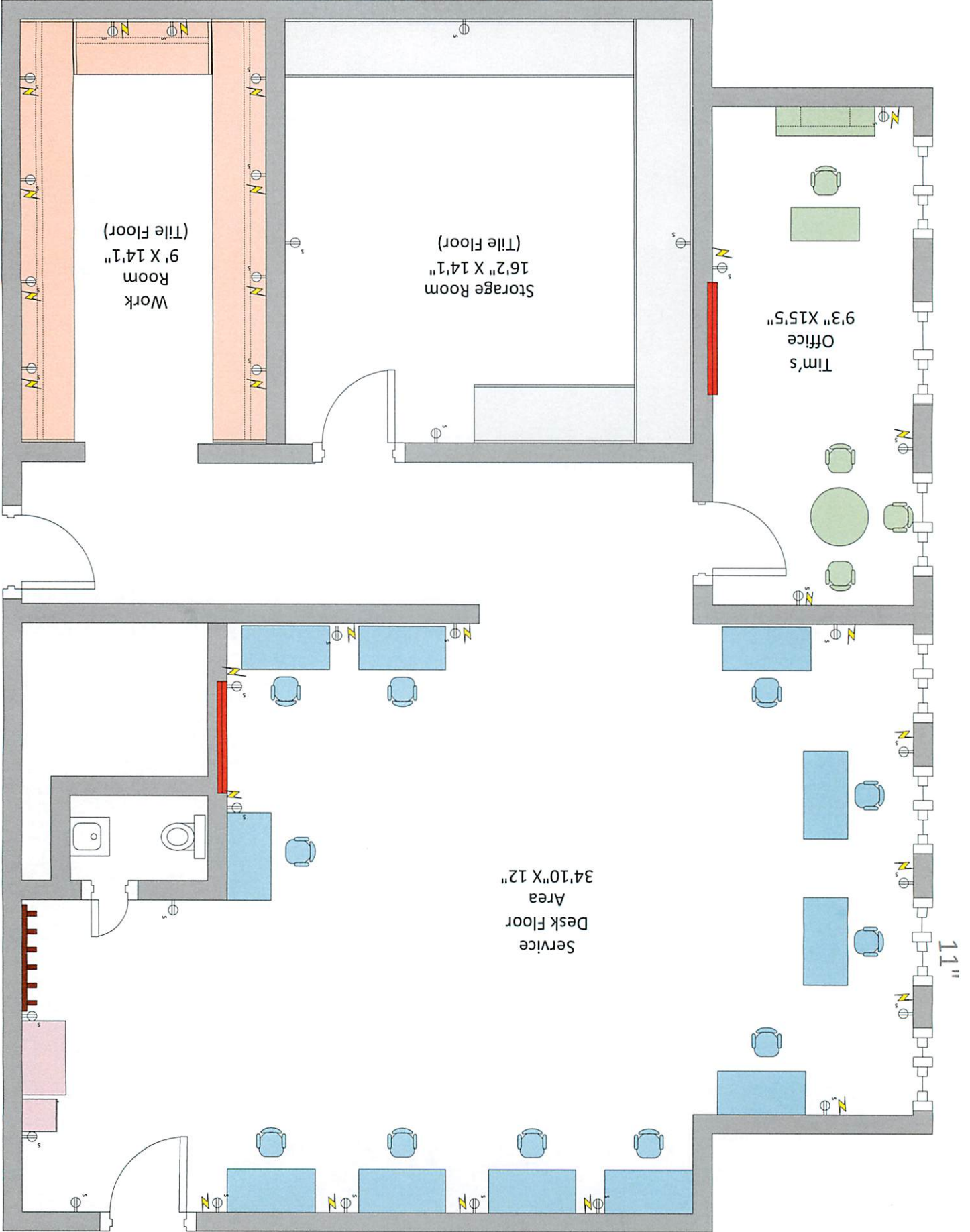

#2

- COPIER
- ICE MACHINE
- COMM ~~CLOSET~~ CLOSET 50A
- ~~RECEPTACLE~~ (2) DEDICATED IN KITCHEN

Building 200 3rd floor

- 1) Any circuits in Center Island in Break room? **NO**
- 2) Any dedicated receptacles required?
- 3) Can you please provide power requirements for the ice machine? **NOT AT THIS TIME.**
- 4) The power requirements for the Comm. Closet? Allow for quad receptacles? **YES**
- 5) The power requirements for Laptop in the Conf. Room? Allow for duplex receptacle? **YES**
- 6) Does the power for the ceiling projector and the Smart Board need to be dedicated? **NO**
- 7) Does the 50A receptacle for the UPS go in the comm./data closet or the work room? **COMM ROOM, ITS FOR THE PHONE UPS**
- 8) Do the power and data outlets in Care Management need to be dedicated? **NO**
- 9) The fire alarm contact number for Hillard has been disconnected. Can you please provide a current telephone number? **HILKER SYSTEMS, INC. 757 549 9123**
- 10) We assume no HVAC power changes are required. **NO ELEC. REQS. FOR HVAC**

* ALSO ATTACHED IS THE POWER/
COMM PLAN FOR THE IT HELP
DESK SPACE.

