



**DEPARTMENT OF THE NAVY**  
NAVAL FACILITIES ENGINEERING COMMAND, MID-ATLANTIC

IN REPLY REFER TO:  
ROICC  
PSC Box 8006  
Cherry Point, NC 28533-006

N40085-see below  
June 8, 2009

**VIA ELECTRONIC MAIL**

N40085-07-D-1907  
Virtexco Corporation  
977 Norfolk Square  
Norfolk, VA 23502-3227

N40085-07-D-1910  
Alderman Building Co. Inc.  
1213-I Country Club Road  
Jacksonville, NC 28546

N40085-07-D-1908  
Joyce & Associates  
P. O. Box 190  
Newport, NC 28570

N40085-07-D-1911  
Pro Construction, Inc.  
2423-C North Marine Blvd.  
Jacksonville, NC 28546

N40085-07-D-1909  
C. L. Price & Associates  
P. O. Box 999  
Newport, NC 28570-0999

N40085-07-D-1912  
Tesoro Corporation  
5250 Challendon Drive  
Virginia Beach, VA 23462

Re: Contract Numbers: See Above, Multiple Award Construction Contract (MACC), Cherry Point, North Carolina

Gentlemen:

In accordance with the contract clause entitled "Ordering of Work" contained in the reference contracts, it is intended to issue a contract task order to the successful offeror for the following project:

**4699739, VARIOUS REPAIRS, B-1791**

A ONE-TIME site visit **will** be conducted for this project on **17 June 2009 at 0900**. Your proposal, to include your cost estimate shall be submitted to the attention of the undersigned at this office by not later than **1400 on 1 July 2009**. Electronic submission of proposals may be made to **roicc\_chpt\_ktr\_bids@navy.mil** and include company name and project number in subject line of email. Receipt of your proposal is subject to FAR 52.215-1, Instruction to Offerors – Competitive Acquisition (JAN 2004) contained in Document 00201. Please note that no bid bond is required.

Your proposal will be reviewed and evaluated based on price and past performance. You will be contacted to discuss minor clarifications or questions concerning your proposal and to establish a specific time if negotiations are conducted. We intend to evaluate proposals and issue a task order without discussions (except communications conducted for the purpose of minor clarification). Therefore, each initial offer should contain the offeror's best terms from a price standpoint. However, the Government reserves the right to conduct discussions if later determined by the Contracting Officer to be necessary.

**The Contract Completion Date (CCD) is 120 days.  
Incorporate the attached Scope of Work into the project/contract.  
Liquidated Damages will be \$140.00 a day.**

You may contact the ROICC at (252) 466-5930 to inspect site conditions, review available as-built drawings (if applicable), or inquire about other on-site technical details. Any changes to the scope of work or technical specifications will be effected on a Standard Form (SF) 30.

This request does not constitute notice to proceed nor shall it be considered as a commitment on the part of the Government. Any costs incurred prior to issuance of a task order cannot be reimbursed. Costs of such nature are considered to be for the benefit of the Contractor and are incurred at his discretion. The successful offeror will be issued a task order, which will take the form of Department of Defense (DD) Form 1155, under their contract as set forth in FAC 5252.216-9306, Procedures for Issuing Orders (NOV 1998). Direction to proceed for each task order issued will be provided upon receipt and approval of an acceptable performance bond and payment bond under each task order.

We appreciate your cooperation in preparing and submitting your proposal. If you have any questions, **send electronic to address: roicc\_chpt\_ktr\_bids@navy.mil and include company name and project number in subject line of email.**

Sincerely,

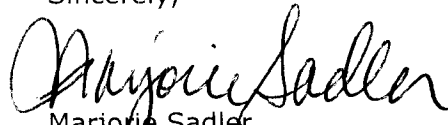
  
Marjorie Sadler  
Contracting Officer

**REPAIR PLUMBING, FLOORS, DOORS AND PAINT THE INTERIOR  
BUILDINGS 1791  
PROJECT NO. 4699739**

**1. GENERAL REQUIREMENTS:** The general intent of this project is to make repairs to the electrical system, flooring replacement, replace plumbing fixtures and personnel doors and paint the interior.

**2. WORK INCLUDES:** Providing all labor, supervision, tools, materials and transportation needed for the completion of the scope of work.

**3. LOCATION:** All work performed will be aboard the Marine Corps Air Station at Cherry Point, North Carolina, building 1791 (Crash Fire and Rescue Building)

**4. SCOPE OF WORK:** All work performed shall be as outlined, denoted and intended in this scope of work.

Demo the existing carpet, floor tile and mastic (asb), 625 sf (12 x 12-gray) in corridor, entry way and 1490 sf (9 x 9-green or red, under gray/black carpet) in the admin office, the crash/rescue office, bunk rooms 1 & 2, crew lounge and offices 1 & 2, (see enclosure 2).

Apply 2 coats of a penetrating encapsulant.

Replace carpet with new Lee's Workforce Modular, 22 oz/sy (#408 Cloud Glow, 24 inch square tiles) follow all manufacturers' recommended installation instructions and adhesives to insure all warranty is honored.

Demolish the two (2 ea) electrical (Federal Pacific) sub panels, one (1 ea) 100A, 4-wire, 120/208 volt panel in the garage area, and one (1 ea) 225A, 120/208 volt, 42 circuit, 4-wire panel in the janitors closet.

Replace both with new Square "D", 3 phase, 4-wire, 120/208 volt, 225 Amp, 42 circuit panel boards, with all the breakers. Both feeds from the main shall be upgraded to support the maximum load. All circuits shall be located and marked.

Demo the partitions, the sinks, commodes and urinals in the bathroom.

Replace the stalls for the commodes, with solid (high density polyethylene) polymer stall partitions (2 ea), and doors (2 ea) beige in color, and new hardware (including coat hooks). Install two (2 ea) toilet paper holders.

**ENCLOSURE (1)**

Replace the two (2 ea) commodes with American Standard Champion Right Height Elongated model 2002.012 commodes complete with new stops (chrome), flush valves and seats.

Replace the three (3 ea) sinks with wall hung, 22 x 19-in, porcelain enamel sinks with delta single lever faucets and stop valves in a chrome finish.  
Replace the two (2 ea) urinals with new wall mounted urinals with new flush valves and stops (chrome).

Replace the three (3 ea) doors, Replace the two (2 ea) single exterior doors and frames with a 3 x 7 ft commercial, insulated, full panel steel doors each with a (safety glass) narrow light, steel frame and all hardware including closers, entry locks (changeable cylinder) and panic hardware.

Replace the interior double doors and frames with commercial steel 16 Ga double (6' x 7' high by 1-3/4") doors (with narrow lights) and frame. Replace with new all hardware, including but not limited to closers, hinges and locking (changeable cylinder) latches (see Enclosure 2).

Prep, prime and paint interior and exterior sides of all 3 new doors and frames with 1 primer coat and 1 finish coat, of exterior latex matching the existing colors.

On all previously painted interior surfaces remove all of the flaking and peeling paint, on all interior walls and ceilings. Removal shall be down to fully adhered surfaces. Fully adhered surfaces shall be defined as remaining paint that cannot be lifted with a putty knife. Repair all damage, fill all holes and leave the surface smooth and unblemished.

On all walls and ceilings apply 1 coat of Zinsser Watertite primer or equivalent to repaired areas and any exposed sub straight.

Apply 1 finish coat to all the interior walls using interior semi-gloss latex enamel FSC No. 27778 (parchment). Apply 1 finish coat to all the ceilings using off-white interior semi-gloss latex enamel FSC No. 27880, approximately 13,000 sf.

Follow manufacturers recommended drying times between all coats.

**5. TERMS OF CONTRACT:** The contractor is responsible for an on-site visit to inspect the work areas and to understand fully the scope of work. All work performed shall be during the hours of 0700-1600, Monday through Friday. Any work performed outside of these periods must be, pre-approved by the Contracting Officer.

This project shall be completed within 120 days.

All Outages requires Contractor's written request fifteen (15) days prior to commencement of such work and Contracting Officer's approval.

**6. JOB EXECUTION:** The contractor shall coordinate thru the Contracting Officer to minimize the impact on the tenant's schedules. The demolition practice and installation shall conform to all industry standards and applications, i.e. all North Carolina Building Codes and Statues, NEC and other OSHA Safety standards as they apply to this project. All equipment and debris generated from this project becomes the property of the contractor. The contractor must remove all equipment and debris from the job site and MCAS Cherry Point and taken to a state certified landfill, at no expense to the government.

# Cherry Point Building 1791-Crash Crew

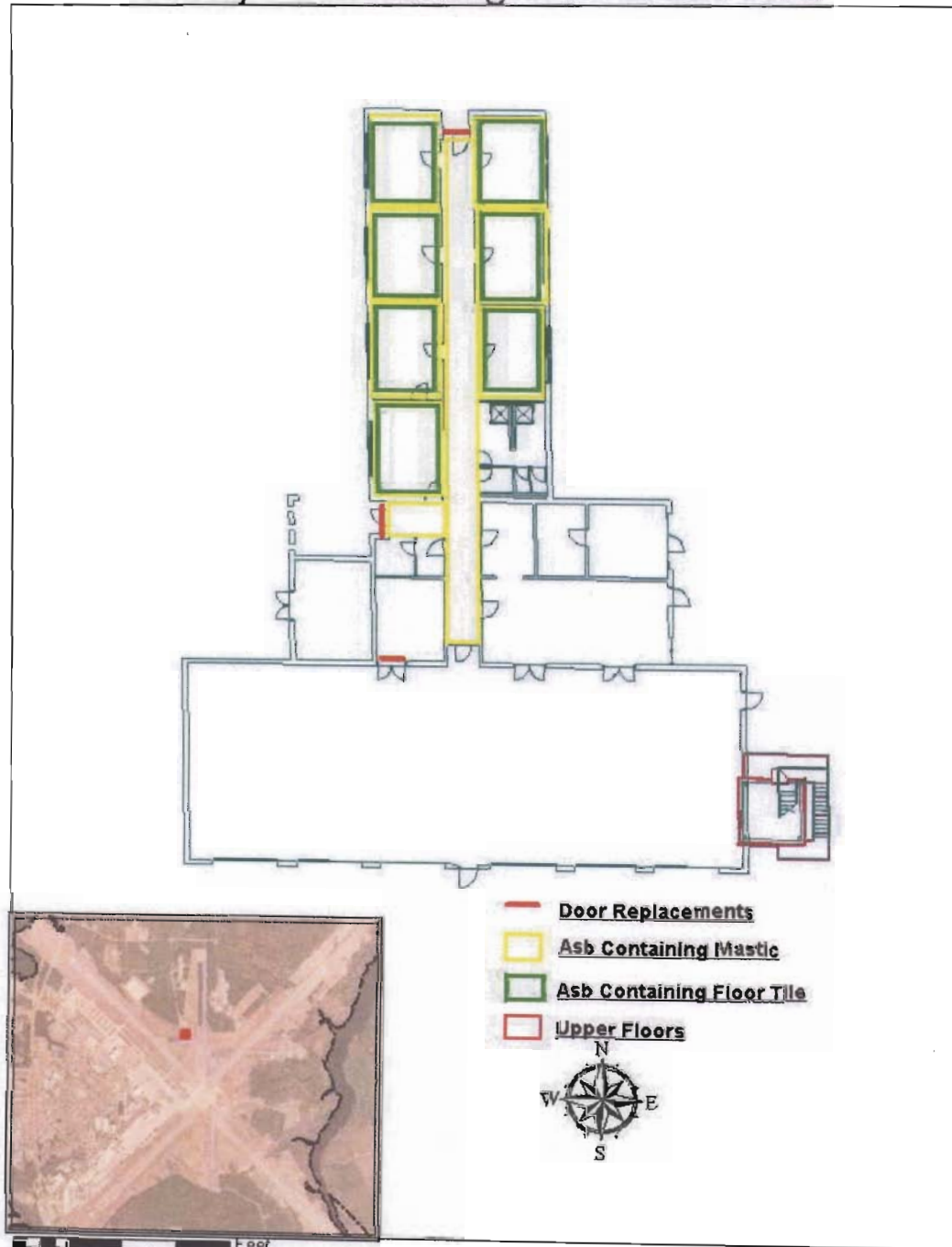

**ENCLOSURE (2)**

**SAMPLE LEGEND ID**

#####-01-01 (-) (-) (-)  
 ASBESTOS SAMPLE IDENTIFICATION  
 POSITIVE (+) OR NEGATIVE (-) FOR  
 THE PRESENCE OF ASBESTOS  
 HOMOGENEOUS AREA #

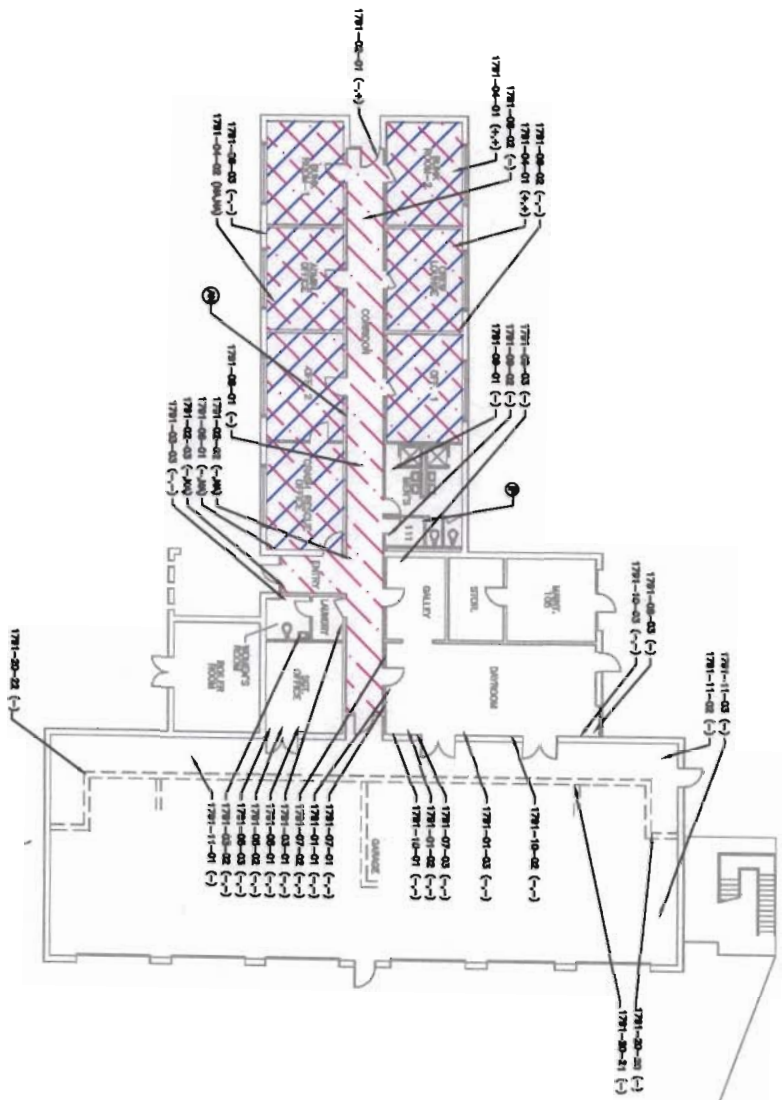

**BUILDING 1791**  
**FIRST FLOOR**

0 2' 4' 6'



**ACM LEGEND:**

RESIDUAL MASTIC, UNDER  
 12" GRAY CHA023

9" GREEN (AND RED) FLOOR  
 TILE MASTIC CHA041

ND ACCESS

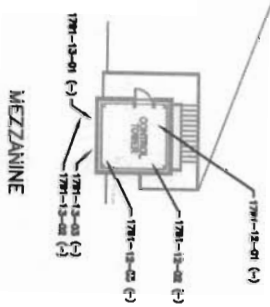

CY07 ASBESTOS REINSPECTION  
 1791-01/07  
 MCAS CHERRY POINT, NC



NO.	REVISIONS

**NAVFAC**  
 N68470-04-D-0654, D080021

General Decision Number: NC080055 02/20/2009 NC55

Superseded General Decision Number: NC20070055

State: North Carolina

Construction Type: Building

County: Craven County in North Carolina.

Modification Number	Publication Date
0	02/08/2008
1	03/07/2008
2	06/06/2008
3	01/30/2009
4	02/13/2009
5	02/20/2009

\* BOIL0030-001 01/01/2009

	Rates	Fringes
Boilermaker.....	\$ 27.63	13.96

Welder:

Pressure welder: \$.75 per hour additional.

-----  
SUNC2000-002 03/21/2000

	Rates	Fringes
Carpenter		
_(includes drywall hanging)...	\$ 9.82	
Cement mason/concrete finisher.....	\$ 9.75	
Electrician.....	\$ 10.18	
Laborer, general.....	\$ 7.17	
Painter, brush.....	\$ 10.00	
Pipefitter		
_(includes HVAC piping).....	\$ 13.50	.93
Plumber		
_(does not include HVAC piping).....	\$ 11.75	.66
Power equipment operators:		
_Backhoe operator.....	\$ 10.54	
Sheet metal worker		
_(includes HVAC duct work)...	\$ 11.56	.97
Truck driver.....	\$ 7.88	

-----  
WELDERS - Receive rate prescribed for craft performing  
operation to which welding is incidental.  
=====

Unlisted classifications needed for work not included within  
the scope of the classifications listed may be added after  
award only as provided in the labor standards contract clauses  
(29CFR 5.5 (a) (1) (ii)).

-----  
In the listing above, the "SU" designation means that rates  
listed under the identifier do not reflect collectively  
bargained wage and fringe benefit rates. Other designations  
indicate unions whose rates have been determined to be  
prevailing.  
-----

#### WAGE DETERMINATION APPEALS PROCESS

1.) Has there been an initial decision in the matter? This can  
be:

- \* an existing published wage determination
- \* a survey underlying a wage determination
- \* a Wage and Hour Division letter setting forth a position on  
a wage determination matter
- \* a conformance (additional classification and rate) ruling

On survey related matters, initial contact, including requests  
for summaries of surveys, should be with the Wage and Hour  
Regional Office for the area in which the survey was conducted  
because those Regional Offices have responsibility for the  
Davis-Bacon survey program. If the response from this initial  
contact is not satisfactory, then the process described in 2.)  
and 3.) should be followed.

With regard to any other matter not yet ripe for the formal  
process described here, initial contact should be with the  
Branch of Construction Wage Determinations. Write to:

Branch of Construction Wage Determinations  
Wage and Hour Division  
U.S. Department of Labor  
200 Constitution Avenue, N.W.  
Washington, DC 20210

2.) If the answer to the question in 1.) is yes, then an  
interested party (those affected by the action) can request  
review and reconsideration from the Wage and Hour Administrator  
(See 29 CFR Part 1.8 and 29 CFR Part 7). Write to:

Wage and Hour Administrator  
U.S. Department of Labor

200 Constitution Avenue, N.W.  
Washington, DC 20210

The request should be accompanied by a full statement of the interested party's position and by any information (wage payment data, project description, area practice material, etc.) that the requestor considers relevant to the issue.

3.) If the decision of the Administrator is not favorable, an interested party may appeal directly to the Administrative Review Board (formerly the Wage Appeals Board). Write to:

Administrative Review Board  
U.S. Department of Labor  
200 Constitution Avenue, N.W.  
Washington, DC 20210

4.) All decisions by the Administrative Review Board are final.

=====

END OF GENERAL DECISION